

TR-962 Dental Operating LED Light

Manual



Read the manual carefully before using the light.

Scope

The operating lights used in the dental office and intended for illuminating the oral cavity of patients.

Structure of the light

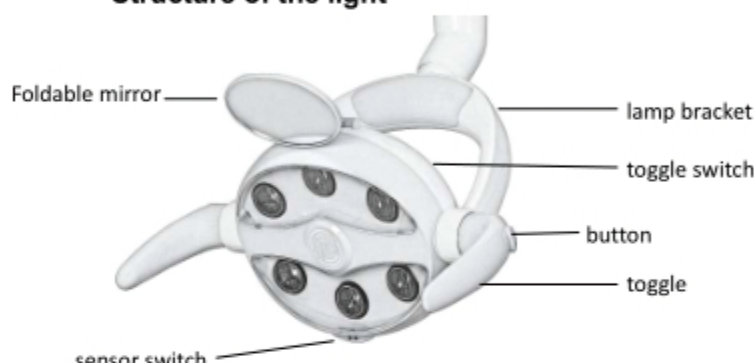

Installation

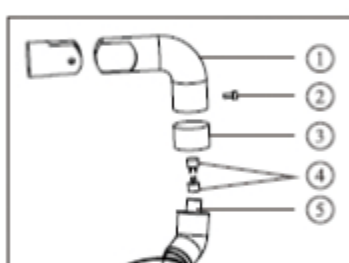

① lamp arm ② screw ③ decoration cover ④connector ⑤connecting shaft

Installation method:

Connect the lamp arm, decoration cover and the connector according to the instruction picture.

Make sure the power source is AC12V-24V.

Working condition

Working condition		Transportation and storage condition	
Temperature	5-40℃	Temperature	-40-70℃
Relative humidity	30-75%	Relative humidity	-10-+100%
Atmospheric pressure	70-106Kpa	Atmospheric pressure	50-106Kpa

Technical specification

Input voltage	AC12V-24V
Power	20VA
Illumination	7000lux-40000lux
Color temperature	5000K-6000K
Net weight	1452g
Gross weight	1952g

Operating instruction

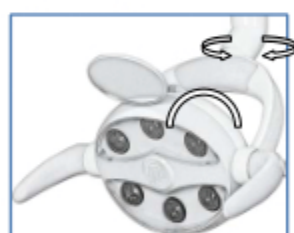

1, Adjust the angle of the toggle according to the picture (on the left to any operation position u prefer.

Loosen the screw to adjust the angle. After the adjustment, tighten the screw for normal use.

Adjust the light operation angle and distance by pulling the toggles.

2, The foldable mirror.

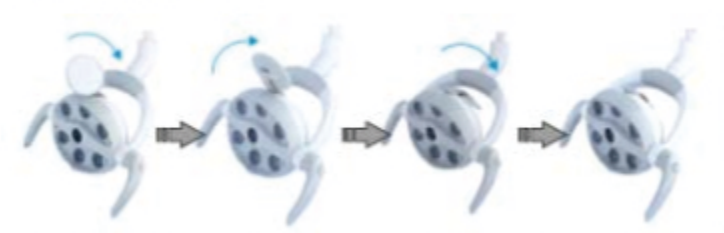

3, There are two switches for the light, sensor switch and toggle switch.

3.1 Touch the toggle switch to turn on or turn off the light .

3.2 Skim the hand over the sensor switch at the bottom to turn on or turn off the light.
(the sensor distance is 0-100mm)

4, Adjust the illumination of the dental operating LED light.

When the dental operating light is working, keep the hand under the sensor switch or press the toggle switch, the light will be into the illumination adjustment mode and gradually increase to the maximum illumination or minimum illumination. When reaching the extremum, there is a sound to remind and stop for 3 seconds, the illumination will turn back.

When the intensity is changing from the minimum to maximum, if u find the proper illumination, remove the hand. Next time turn on the lights, the illumination u used last time will be memorized.

Maintenance & Attention

Clean via the 3-function sprayer or soft cotton and wet tissue.

The toggle can be taken off and disinfected under the high temperature.

Notice:

Don't use the caustic cleaning solution or the rough cloth to clean or rub the light.